



● Features:

- *Utilizes a pressure sensor packaged in a SST316L housing. Pressure is transferred from a stainless steel diaphragm to the sensor.
- * A broad compensated temperature range of -20 to 85°C and excellent temperature compensation make this transducer/transmitter very stable fluctuating temperatures.
- * 1 year warranty

● Applications:

- * Process control system, liquid level measurement, gas compressors
- * Lubrication systems, natural gas production, chemical processing
- * Waste water treatment, pulp & paper processing, oil production, recovery and others.



Specifications	
Range	0~5000psi
Output	4 mA (Zero) 20 mA (Full scales)
Total Accuracy	≤ 1.0%FS, 0.5%FS, 0.25%FS, 0.1%FS (the compensated temperature range)
Long Term Stability	will repeat within 0.5%FS, 0.25%FS, 0.1%FS of original calibration curve for one year
Safe Pressure	150% full scale
Proof Pressure	250% full scale
Cycling life	In excess of 106 cycles at full scale pressure

● PTD Series Product Code

Range	Over-pressure	Burst Pressure	Product Code
0-15psi	22.5psi	30psi	TMP32
0-30psi	45psi	60psi	TMP33
0-60psi	90psi	120psi	TMP34
0-100psi	150psi	200psi	TMP35
0-150psi	225psi	300psi	TMP36
0-200psi	300psi	400psi	TMP37
0-300psi	450psi	600psi	TMP38
0-600psi	900psi	1200psi	TMP39
0-1000psi	1500psi	2000psi	TMP310
0-1500psi	2250psi	3000psi	TMP311
0-2000psi	3000psi	4000psi	TMP312
0-3000psi	4500psi	6000psi	TMP313
0-5000psi	7500psi	10000psi	TMP314

● Hirschmann Socket Type

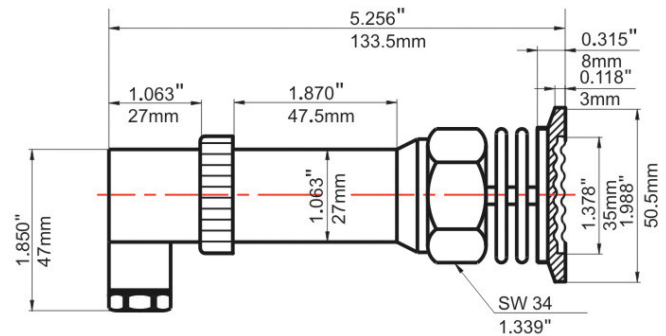

● Cable Type

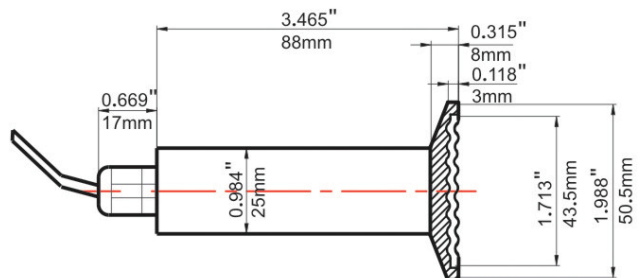

● Aerospace Plug Type

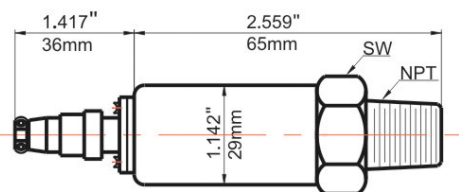

● Environmental:

- * Compensated Temperature Range: -20 ~ 75°C
- * Operating Temperature Rang:-30 ~ 85°C
- * Storage Temperature Range:-40 ~ 100°C
- * Vibration: 15 grms 10-2000Hz(MIL-STD-202 M204 Cond.B)
- * Shock: 50g's, 11ms, (MIL-STD-202 M213 Cond.G)

● Electrical Connection:

1. For transducer/sensor:

- * Green(1#) - signal output positive (S+), white(3#) - signal output negative (S-)
- * Red(2#) - power supply positive(E+), black(4#) - power supply negative(E-)
- * Black & longth(5#) - shield

2. For Transmitter:

- * 4 - 20mA(2-wire): Red(1#) - power supply(E+),
Green (2#) - Output/power supply(E-)
- * 0/4 - 10/20mA(3 wire): Red(1#) - power supply(E+),
Black(2#) - power supply(E-),
Green(3#) - signal output(Iout)
- * 0/1 - 5/10V(3 wire): Red(1#) - power supply(E+),
Black(2#) - power supply(E-),
Green(3#) - signal output(Vout)

● Wiring Schematic:

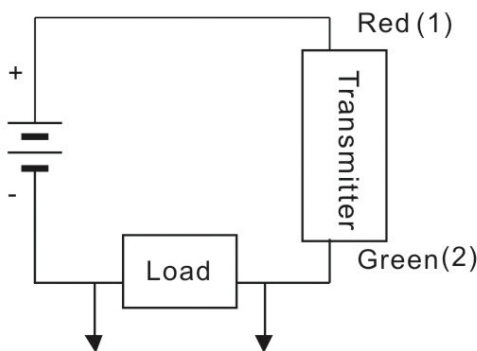

● 2-wire Transmitter

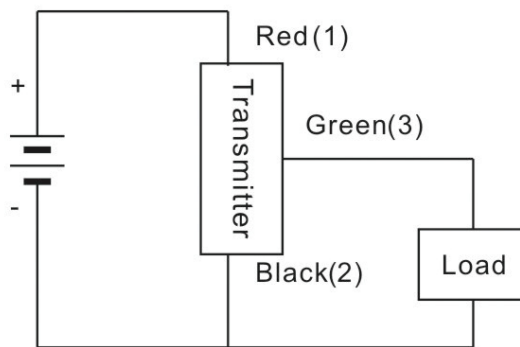

● 3-wire Transmitter

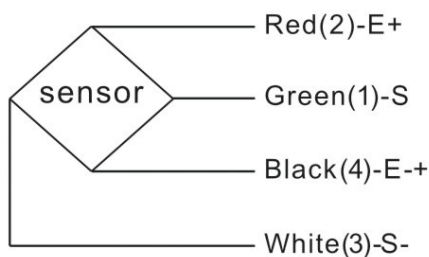

● 4-wire Transmitter



● Type Selections:

Model	Housing body size	Output	Pressure Range
PTD	1 – 2715	0 – mV(for Sensor)	xx - Rated pressure measurement value unit – may be select: MPa、KPa、 Pa、 Bar、 PSI、 Kg/cm ²
	2 – 2755	1 – 420mA (2 wire)	
	3 – 2955	2 – 420mA (3 wire)	
	9 – other	3 – 05V	
		4 – 15V	
		5 – 0.54.5V	
		6 – 010V	
		7 – switch out	
		8 – switch & voltage out	
	9 – customer special requests		

Model	Port Screw	Electrical Connection	Additional Function
PTD	Mark the real port screw.	P1 - 1 meter shielded cable	A1 – 1.0%FS
		P2 - large Hirschmann	A2 – 0.5%FS
		P3 - aerospace plug(steel)	A3 – 0.25%FS
		P4 - small Hirschmann	A4 – 0.1%FS
		P5 - aerospace plug(alloy)	V1 – 24VDC
		P6 - 2088 alloy enclosure	V2 – 12VDC
		P7 - BP2-1 alloy enclosure	V3 – 5VDC
			V4 – 12VDC
			D1 – LED display
			D2 – LCD display
			D3 – index display
			D4 – 0100% display
			SS–self-safety ialICT4
	SI – isolation dIIBT4		
	DNxx- Flange & num.		

● Ordering Example:

- * PTD 10-20MPa-M201.5-P3A2 -- PTD pressure transducer/sensor: gauge pressure range is 0-20MPa, housing body size is 2715, output is mV(sensor,4 wire), port screw is M20x1.5, electrical connection is aerospace plug(stainless), accuracy is 0.5%FS.
- * PTD 21-25MPa- M20x1.5-P2A3V1D1 -- PTD pressure transmitter: gauge pressure range is 0-25MPa, housing body size is 2755, output is 4-20mA(2 wire), port screw is M20x1.5, electrical connection is large Hirschmann, accuracy is 0.25%FS, the power supply is 24VDC, LED displays the processing values.
- * PTD 16-1.0MPa- DN25-P3A2V1 -- PTD pressure transmitter: gauge pressure range is 0-1.0MPa, housing body size is 2755, output is 0-10V(3 wire), mechanical port is DN25, electrical connection is aerospace socket(stainless), accuracy is 0.5%FS, the power supply is 24VDC.