



● Features:

- * Dial: 2"(50mm), 2.5"(63mm), 3"(75mm), 4"(100mm), 6"(150mm)
white aluminium dials with black and red markings
- * Case style: **Bayonet**, Stainless steel 304
- * Socket: Brass, lead free brass or stainless steel 304
- * Glycerine-filled or dry with filling hole
- * Restrictor in connection
- * ASME B40.100 and EN837-1 compliant

● Applications:

- * With liquid-filled case for applications with high dynamic pressure pulsations or vibration
- * Suitable for corrosive environments and gaseous or liquid media that will not obstruct the pressure system
- * Process industry: chemical / petrochemical, power stations, mining, on and offshore, environmental technology, mechanical engineering and plant construction

Specifications	
Dial	2"(50mm), 2.5"(63mm), 3"(75mm), 4"(100mm), 6"(150mm)
Case	Stainless steel 304, polished or matte (not bright)
Lens	Polycarbonate window, armored glass or safety glass, Bayonet bezel
Socket	Brass, lead free brass or stainless steel
Connection	1/8"NPT, 1/4"NPT or 1/2"NPT
Movement	Brass
Pointer	Black aluminium
Welding	Silver alloy
Over-pressure Limit	25% of full scale value
Working Pressure	Maximum 80% of full scale value
Ambient/Process Temperature	-40°F to 150°F (-40°C to 65°C)
Liquid-filled	Glycerine-filled or dry with filling hole
Accuracy	Dial 2": ±3-2-3% Grade B
	Dial 2.5", 3": ±3-2-3% Grade B (±1.6% available)
	Dial 4", 6": ±1.6% (±1.0% available)



Option Explanation:

1. For all the following options, need special instructions in writing.

- * Socket material is Lead free brass, SS304, SS316 or 316L etc.
- * Case surface is Polished or Matte (not bright).
- * The gauge is Liquid-filled or Dry with filling hole.
- * Bottom connection with Back flange, and the flange is Removable or Fixed.
- * Back connection with Front flange, and the flange is Removable or Fixed.
- * Back connection with U-clamp.
- * Socket and internals are **separated** and screwed together with the case.
- * Socket and internals are **completed** and fixed with case by screws on the back.



2. All the product codes in following sheets don't include above option items.

PEP Series Product Code (Scales kPa, bar, kg/cm²... available)

Dial Size	2" (50mm)			
	1/8" Bottom	1/8" Center Back	1/8" Bottom	1/8" Center Back
Socket	Brass		SS	
30"Hg Vac	P22L2830V	P22B2830V	P32L2830V	P32B2830V
30"/0/15 psi	P22L28301	P22B28301	P32L28301	P32B28301
30"/0/30 psi	P22L28302	P22B28302	P32L28302	P32B28302
30"/0/60 psi	P22L28303	P22B28303	P32L28303	P32B28303
30"/0/100 psi	P22L28304	P22B28304	P32L28304	P32B28304
30"/0/160 psi	P22L28305	P22B28305	P32L28305	P32B28305
30"/0/200 psi	P22L28306	P22B28306	P32L28306	P32B28306
30"/0/300 psi	P22L28307	P22B28307	P32L28307	P32B28307
0/15 psi	P22L281	P22B281	P32L281	P32B281
0/30 psi	P22L282	P22B282	P32L282	P32B282
0/60 psi	P22L283	P22B283	P32L283	P32B283
0/100 psi	P22L284	P22B284	P32L284	P32B284
0/160 psi	P22L285	P22B285	P32L285	P32B285
0/200 psi	P22L286	P22B286	P32L286	P32B286
0/300 psi	P22L287	P22B287	P32L287	P32B287
0/400 psi	P22L288	P22B288	P32L288	P32B288
0/600 psi	P22L289	P22B289	P32L289	P32B289
0/1,000 psi	P22L2810	P22B2810	P32L2810	P32B2810
0/1,500 psi	P22L2811	P22B2811	P32L2811	P32B2811
0/2,000 psi	P22L2812	P22B2812	P32L2812	P32B2812
0/3,000 psi	P22L2813	P22B2813	P32L2813	P32B2813
0/4,000 psi	P22L2814	P22B2814	P32L2814	P32B2814
0/5,000 psi	P22L2815	P22B2815	P32L2815	P32B2815
0/6,000 psi	P22L2816	P22B2816	P32L2816	P32B2816
0/7,500 psi	P22L2817	P22B2817	P32L2817	P32B2817
0/1,0000 psi	/	/	P32L2818	P32B2818



Dial Size	2" (50mm)				2.5" (63mm)			
	1/4" Bottom		1/4" Center Back		1/4" Bottom		1/4" Center Back	
NPT Connection	Brass		SS		Brass		SS	
Socket	Brass		SS		Brass		SS	
30"Hg Vac	P22L2430V	P22B2430V	P32L2430V	P32B2430V	P22L3430V	P22B3430V	P32L3430V	P32B3430V
30"/0/15 psi	P22L24301	P22B24301	P32L24301	P32B24301	P22L34301	P22B34301	P32L34301	P32B34301
30"/0/30 psi	P22L24302	P22B24302	P32L24302	P32B24302	P22L34302	P22B34302	P32L34302	P32B34302
30"/0/60 psi	P22L24303	P22B24303	P32L24303	P32B24303	P22L34303	P22B34303	P32L34303	P32B34303
30"/0/100 psi	P22L24304	P22B24304	P32L24304	P32B24304	P22L34304	P22B34304	P32L34304	P32B34304
30"/0/160 psi	P22L24305	P22B24305	P32L24305	P32B24305	P22L34305	P22B34305	P32L34305	P32B34305
30"/0/200 psi	P22L24306	P22B24306	P32L24306	P32B24306	P22L34306	P22B34306	P32L34306	P32B34306
30"/0/300 psi	P22L24307	P22B24307	P32L24307	P32B24307	P22L34307	P22B34307	P32L34307	P32B34307
0/15 psi	P22L241	P22B241	P32L241	P32B241	P22L341	P22B341	P32L341	P32B341
0/30 psi	P22L242	P22B242	P32L242	P32B242	P22L342	P22B342	P32L342	P32B342
0/60 psi	P22L243	P22B243	P32L243	P32B243	P22L343	P22B343	P32L343	P32B343
0/100 psi	P22L244	P22B244	P32L244	P32B244	P22L344	P22B344	P32L344	P32B344
0/160 psi	P22L245	P22B245	P32L245	P32B245	P22L345	P22B345	P32L345	P32B345
0/200 psi	P22L246	P22B246	P32L246	P32B246	P22L346	P22B346	P32L346	P32B346
0/300 psi	P22L247	P22B247	P32L247	P32B247	P22L347	P22B347	P32L347	P32B347
0/400 psi	P22L248	P22B248	P32L248	P32B248	P22L348	P22B348	P32L348	P32B348
0/600 psi	P22L249	P22B249	P32L249	P32B249	P22L349	P22B349	P32L349	P32B349
0/1,000 psi	P22L2410	P22B2410	P32L2410	P32B2410	P22L3410	P22B3410	P32L3410	P32B3410
0/1,500 psi	P22L2411	P22B2411	P32L2411	P32B2411	P22L3411	P22B3411	P32L3411	P32B3411
0/2,000 psi	P22L2412	P22B2412	P32L2412	P32B2412	P22L3412	P22B3412	P32L3412	P32B3412
0/3,000 psi	P22L2413	P22B2413	P32L2413	P32B2413	P22L3413	P22B3413	P32L3413	P32B3413
0/4,000 psi	P22L2414	P22B2414	P32L2414	P32B2414	P22L3414	P22B3414	P32L3414	P32B3414
0/5,000 psi	P22L2415	P22B2415	P32L2415	P32B2415	P22L3415	P22B3415	P32L3415	P32B3415
0/6,000 psi	P22L2416	P22B2416	P32L2416	P32B2416	P22L3416	P22B3416	P32L3416	P32B3416
0/7,500 psi	P22L2417	P22B2417	P32L2417	P32B2417	P22L3417	P22B3417	P32L3417	P32B3417
0/1,0000 psi	P22L2418	P22B2418	P32L2418	P32B2418	P22L3418	P22B3418	P32L3418	P32B3418
0/1,5000 psi	/	/	/	/	/	/	/	/

Dial Size	3" (75mm)				4" (100mm)			
	1/4" Bottom		1/4" Center Back		1/4" Bottom		1/4" Center Back	
NPT Connection	Brass		SS		Brass		SS	
Socket	Brass		SS		Brass		SS	
30"Hg Vac	P22L4430V	P22B4430V	P32L4430V	P32B4430V	P22L5430V	P22B5430V	P32L5430V	P32B5430V
30"/0/15 psi	P22L44301	P22B44301	P32L44301	P32B44301	P22L54301V	P22B54301V	P32L54301V	P32B54301V
30"/0/30 psi	P22L44302	P22B44302	P32L44302	P32B44302	P22L54302V	P22B54302V	P32L54302V	P32B54302V
30"/0/60 psi	P22L44303	P22B44303	P32L44303	P32B44303	P22L54303V	P22B54303V	P32L54303V	P32B54303V
30"/0/100 psi	P22L44304	P22B44304	P32L44304	P32B44304	P22L54304V	P22B54304V	P32L54304V	P32B54304V
30"/0/160 psi	P22L44305	P22B44305	P32L44305	P32B44305	P22L54305V	P22B54305V	P32L54305V	P32B54305V
30"/0/200 psi	P22L44306	P22B44306	P32L44306	P32B44306	P22L54306V	P22B54306V	P32L54306V	P32B54306V
30"/0/300 psi	P22L44307	P22B44307	P32L44307	P32B44307	P22L54307V	P22B54307V	P32L54307V	P32B54307V
0/15 psi	P22L441	P22B441	P32L441	P32B441	P22L541	P22B541	P32L541	P32B541
0/30 psi	P22L442	P22B442	P32L442	P32B442	P22L542	P22B542	P32L542	P32B542
0/60 psi	P22L443	P22B443	P32L443	P32B443	P22L543	P22B543	P32L543	P32B543
0/100 psi	P22L444	P22B444	P32L444	P32B444	P22L544	P22B544	P32L544	P32B544
0/160 psi	P22L445	P22B445	P32L445	P32B445	P22L545	P22B545	P32L545	P32B545
0/200 psi	P22L446	P22B446	P32L446	P32B446	P22L546	P22B546	P32L546	P32B546
0/300 psi	P22L447	P22B447	P32L447	P32B447	P22L547	P22B547	P32L547	P32B547
0/400 psi	P22L448	P22B448	P32L448	P32B448	P22L548	P22B548	P32L548	P32B548
0/600 psi	P22L449	P22B449	P32L449	P32B449	P22L549	P22B549	P32L549	P32B549
0/1,000 psi	P22L4410	P22B3510	P32L4410	P32B4410	P22L5410	P22B3510	P32L5410	P32B5410
0/1,500 psi	P22L4411	P22B3511	P32L4411	P32B4411	P22L5411	P22B3511	P32L5411	P32B5411
0/2,000 psi	P22L4412	P22B3512	P32L4412	P32B4412	P22L5412	P22B3512	P32L5412	P32B5412
0/3,000 psi	P22L4413	P22B3513	P32L4413	P32B4413	P22L5413	P22B3513	P32L5413	P32B5413
0/4,000 psi	P22L4414	P22B3514	P32L4414	P32B4414	P22L5414	P22B3514	P32L5414	P32B5414
0/5,000 psi	P22L4415	P22B3515	P32L4415	P32B4415	P22L5415	P22B3515	P32L5415	P32B5415
0/6,000 psi	P22L4416	P22B3516	P32L4416	P32B4416	P22L5416	P22B3516	P32L5416	P32B5416
0/7,500 psi	P22L4417	P22B3517	P32L4417	P32B4417	P22L5417	P22B3517	P32L5417	P32B5417
0/1,0000 psi	P22L4418	P22B3518	P32L4418	P32B4418	P22L5418	P22B3518	P32L5418	P32B5418
0/1,5000 psi	/	/	P32L4419	P32B4419	/	/	P32L5419	P32B5419



Dial Size	4" (100mm)						6" (150mm)	
	1/2" Bottom	1/2" Center Back	1/2" Lower Back	1/2" Bottom	1/2" Center Back	1/2" Lower Back	1/2" Bottom	1/2" Bottom
NPT Connection	Brass			SS			Brass	SS
Socket	Brass			SS			Brass	SS
30"Hg Vac	P22L5230V	P22B5230V	P22LB5230V	P32L5230V	P32B5230V	P32LB5230V	P22L7230V	P32L7230V
30"/0/15 psi	P22L52301	P22B52301	P22LB52301	P32L52301	P32B52301	P32LB52301	P22L72301	P32L72301
30"/0/30 psi	P22L52302	P22B52302	P22LB52302	P32L52302	P32B52302	P32LB52302	P22L72302	P32L72302
30"/0/60 psi	P22L52303	P22B52303	P22LB52303	P32L52303	P32B52303	P32LB52303	P22L72303	P32L72303
30"/0/100 psi	P22L52304	P22B52304	P22LB52304	P32L52304	P32B52304	P32LB52304	P22L72304	P32L72304
30"/0/160 psi	P22L52305	P22B52305	P22LB52305	P32L52305	P32B52305	P32LB52305	P22L72305	P32L72305
30"/0/200 psi	P22L52306	P22B52306	P22LB52306	P32L52306	P32B52306	P32LB52306	P22L72306	P32L72306
30"/0/300 psi	P22L52307	P22B52307	P22LB52307	P32L52307	P32B52307	P32LB52307	P22L72307	P32L72307
0/15 psi	P22L521	P22B521	P22LB521	P32L521	P32B521	P32LB521	P22L721	P32L721
0/30 psi	P22L522	P22B522	P22LB522	P32L522	P32B522	P32LB522	P22L722	P32L722
0/60 psi	P22L523	P22B523	P22LB523	P32L523	P32B523	P32LB523	P22L723	P32L723
0/100 psi	P22L524	P22B524	P22LB524	P32L524	P32B524	P32LB524	P22L724	P32L724
0/160 psi	P22L525	P22B525	P22LB525	P32L525	P32B525	P32LB525	P22L725	P32L725
0/200 psi	P22L526	P22B526	P22LB526	P32L526	P32B526	P32LB526	P22L726	P32L726
0/300 psi	P22L527	P22B527	P22LB527	P32L527	P32B527	P32LB527	P22L727	P32L727
0/400 psi	P22L528	P22B528	P22LB528	P32L528	P32B528	P32LB528	P22L728	P32L728
0/600 psi	P22L529	P22B529	P22LB529	P32L529	P32B529	P32LB529	P22L729	P32L729
0/1,000 psi	P22L5210	P22B5210	P22LB5210	P32L5210	P32B5210	P32LB5210	P22L7210	P32L7210
0/1,500 psi	P22L5211	P22B5211	P22LB5211	P32L5211	P32B5211	P32LB5211	P22L7211	P32L7211
0/2,000 psi	P22L5212	P22B5212	P22LB5212	P32L5212	P32B5212	P32LB5212	P22L7212	P32L7212
0/3,000 psi	P22L5213	P22B5213	P22LB5213	P32L5213	P32B5213	P32LB5213	P22L7213	P32L7213
0/4,000 psi	P22L5214	P22B5214	P22LB5214	P32L5214	P32B5214	P32LB5214	P22L7214	P32L7214
0/5,000 psi	P22L5215	P22B5215	P22LB5215	P32L5215	P32B5215	P32LB5215	P22L7215	P32L7215
0/6,000 psi	P22L5216	P22B5216	P22LB5216	P32L5216	P32B5216	P32LB5216	P22L7216	P32L7216
0/7,500 psi	P22L5217	P22B5217	P22LB5217	P32L5217	P32B5217	P32LB5217	P22L7217	P32L7217
0/1,0000 psi	P22L5218	P22B5218	P22LB5218	P32L5218	P32B5218	P32LB5218	P22L7218	P32L7218
0/1,5000 psi	/	/	/	P32L5219	P32B5219	P32LB5219	/	P32L7219

● Bottom Connection

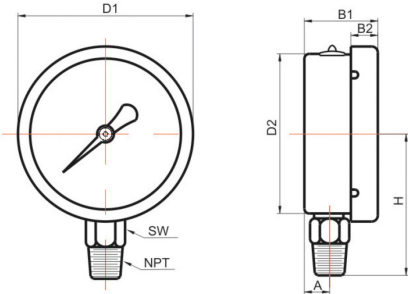

● Back Connection

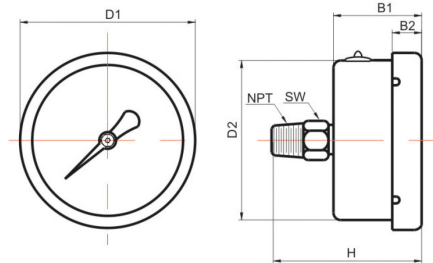

Dial Size	D1	D2	B1	B2	A	H	SW
2"	2.283" (58mm)	2.008" (51mm)	1.122" (28.5mm)	0.354" (9mm)	0.394" (10mm)	2.047" (52mm)	0.551" (14mm)
2.5"	2.717" (69mm)	2.441" (62mm)	1.220" (31mm)	0.413" (10.5mm)	0.394" (10mm)	2.244" (57mm)	0.551" (14mm)
3"	3.543" (90mm)	3.150" (80mm)	1.378" (35mm)	0.551" (14mm)	0.433" (11mm)	2.638" (67mm)	0.551" (14mm)
4"	4.291" (109mm)	3.878" (98.5mm)	1.535" (39mm)	0.571" (14.5mm)	0.512" (13mm)	3.189" (81mm)	0.866" (22mm)
6"	6.339" (161mm)	5.846" (148.5mm)	1.969" (50mm)	0.689" (17.5mm)	0.591" (15mm)	4.291" (109mm)	0.866" (22mm)

Dial Size	D1	D2	B1	B2	H	SW
2"	2.283" (58mm)	2.008" (51mm)	1.122" (28.5mm)	0.354" (9mm)	2.146" (54.5mm)	0.551" (14mm)
2.5"	2.717" (69mm)	2.441" (62mm)	1.220" (31mm)	0.413" (10.5mm)	2.244" (57mm)	0.551" (14mm)
3"	3.543" (90mm)	3.150" (80mm)	1.378" (35mm)	0.551" (14mm)	2.520" (64mm)	0.551" (14mm)
4"	4.291" (109mm)	3.878" (98.5mm)	1.535" (39mm)	0.571" (14.5mm)	2.756" (70mm)	0.866" (22mm)
6"	6.339" (161mm)	5.846" (148.5mm)	1.969" (50mm)	0.689" (17.5mm)	3.465" (88mm)	0.866" (22mm)